

OTHER SIDE

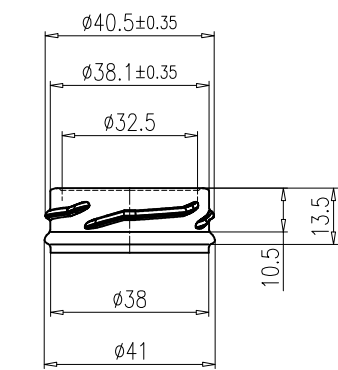

43mm-FD 157A

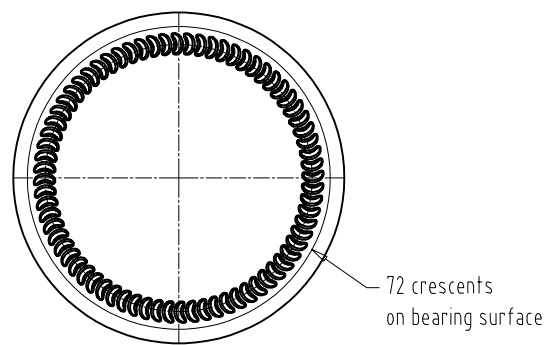

BOTTOM VIEW

L=0.737

耐水性能/HYDROLYTIC RESISTANCE	*** 级/grade
应力等级/TRESS	≤ 4 级/grade
垂直负荷/VERTICAL LOAD	≥ *** N
抗冲击力/IMPACT STRENGTH	≥ *** J
内压强度/INTERNAL PRESSURE	≥ *** MPa
抗热震性能/THERMAL SHOCK	≥ 42 °C
瓶口椭圆度/OVALITY FINISH	≤ *** mm
瓶身椭圆度/OVALITY BODY	≤ 2.4 mm
垂直轴偏差/VERTICALITY	≤ 3.0 mm
口平面不平度/BENT FINISH	≤ 0.3 mm
口对底平行度/HORIZONTALITY	≤ 0.8 mm
瓶肩壁厚/SHOULDER THICKNESS	≥ 1.0 mm
瓶身壁厚/BODY THICKNESS	≥ 1.0 mm
瓶跟壁厚/HEEL CONTACT THICKNESS	≥ 1.0 mm
瓶底壁厚/BASE THICKNESS	≥ 2.0 mm

技术规范/SPECIFICATION	hot finish coating	
	hot end coating	
	cold end coating	

客户批准信息/CUSTOMER APPROVAL	
审批意见 DESIGNATION	
签字/SIGNATURE	
日期/DATE	

满口容量 BRIMFUL CAP	1030 ± 12	CC	成型工艺 PROCESS	PB	设计/DESIGN	L.T.	04-03-2020	D/M/Y	瓶口标准 FINISH	43mm-FD157A	图纸版次/REV.
灌装容量 FILLING CAP	1000 REF.	CC	玻璃料色 COLOR		审核/REVISION				产品编号 REGISTER		2
灌装线 FILLING LEVEL	30	mm	翻到角度 TILT ANGLE	15.38°	批准/APPROVE				产品名称 JOB NAME	1000ml Xtra	
重量 WEIGHT	350±10	g	比例/SCALE		1:1	图纸尺寸使用单位 ALL DIMENSIONS ARE IN		mm			
客户名称/CUSTOMER	兄弟玻璃模具有限公司享有图纸所有权!未经允许,不得复制、使用、转抄					Brother Glass Mould MFG Co.,Ltd					